

Welcome to the...

CENTRAL CALIFORNIA Early Stars Quality Rating Improvement System Summit



PROGRAM

March 25, 2015

Radisson Hotel and Conference Center
1055 Van Ness Avenue
Fresno, California 93721



fresno county
office of education
Jim A. Yovino, Superintendent



Bright futures begin today

WELCOME



JIM A. YOVINO
SUPERINTENDENT, FRESNO COUNTY OFFICE OF EDUCATION

Welcome to the Central California Early Stars Quality Rating and Improvement System (QRIS) Summit! It is our pleasure to be hosting this event. We are deeply committed to ensuring that all of California's young children have access to high-quality early care and education.

It has been an exciting few years in the field of early care and education. From California receiving the Race to the Top – Early Learning Challenge Grant to counties and regions banding together to implement the QRIS, states throughout the country are now looking to California to learn valuable lessons about improving early care and education. Now more than ever is a time for us to share our lessons learned that will pave the way for future quality improvement efforts.

During today's summit you will hear from practitioners in the field of early care and education who have tremendous experience designing, implementing, and sustaining a QRIS. This QRIS Summit will offer valuable examples of best practices, strategies, and resources that we hope will assist in building the capacity of educators to improve the quality of early care and education that young children receive.

Thank you for your attendance today and for making high-quality early care and education a priority for young children and families throughout California.

Sincerely,

Jim Yovino
Superintendent

KEYNOTE SPEAKER



CAMILLE MABEN **EXECUTIVE DIRECTOR, FIRST 5 CALIFORNIA**

In December 2012 Camille Maben began serving in her current role as Executive Director of First 5 California. In that role, she is responsible for staffing the California Children and Families Commission, in addition to directing the work of the agency and its staff. Through her leadership, First 5 California is implementing several evidence-based and results-driven Signature Programs targeted to children, parents, and teachers that focus on quality.

Prior to her appointment at First 5 California, Camille served as the Division Director of the Child Development Division at the California Department of Education (CDE). Part of her responsibilities in that role included providing leadership and oversight to over 700 early care and education contractors with a 1.7 billion dollar budget. She most recently served as Co-Chair of the State Advisory Council on Early Learning and Care and also helped win and implement the \$52.6 million federal Race to the Top - Early Learning Challenge Grant.

She was previously appointed by the Governor to serve as Chief of Staff for the Office of the Secretary of Education. She worked closely with the Secretary on the coordination and development of the Governor's education policy agenda.

In earlier work at CDE, Camille served as Division Director of the School and District Accountability Division. Her division included the No Child Left Behind Office, oversight of the Categorical Program Monitoring process, the Title I Policy and Partnerships Unit, and the English Learner Accountability Unit. She served as the Superintendent's representative to the California Interscholastic Federation. Camille also served as Senior Advisor to former State Superintendent Delaine Eastin and has worked as a consultant to the Assembly Education Committee.

Camille currently serves as a school board member for the Rocklin Unified School District. She has served on the Rocklin Board for over 20 years.

RADISSON HOTEL, FRESNO, CA

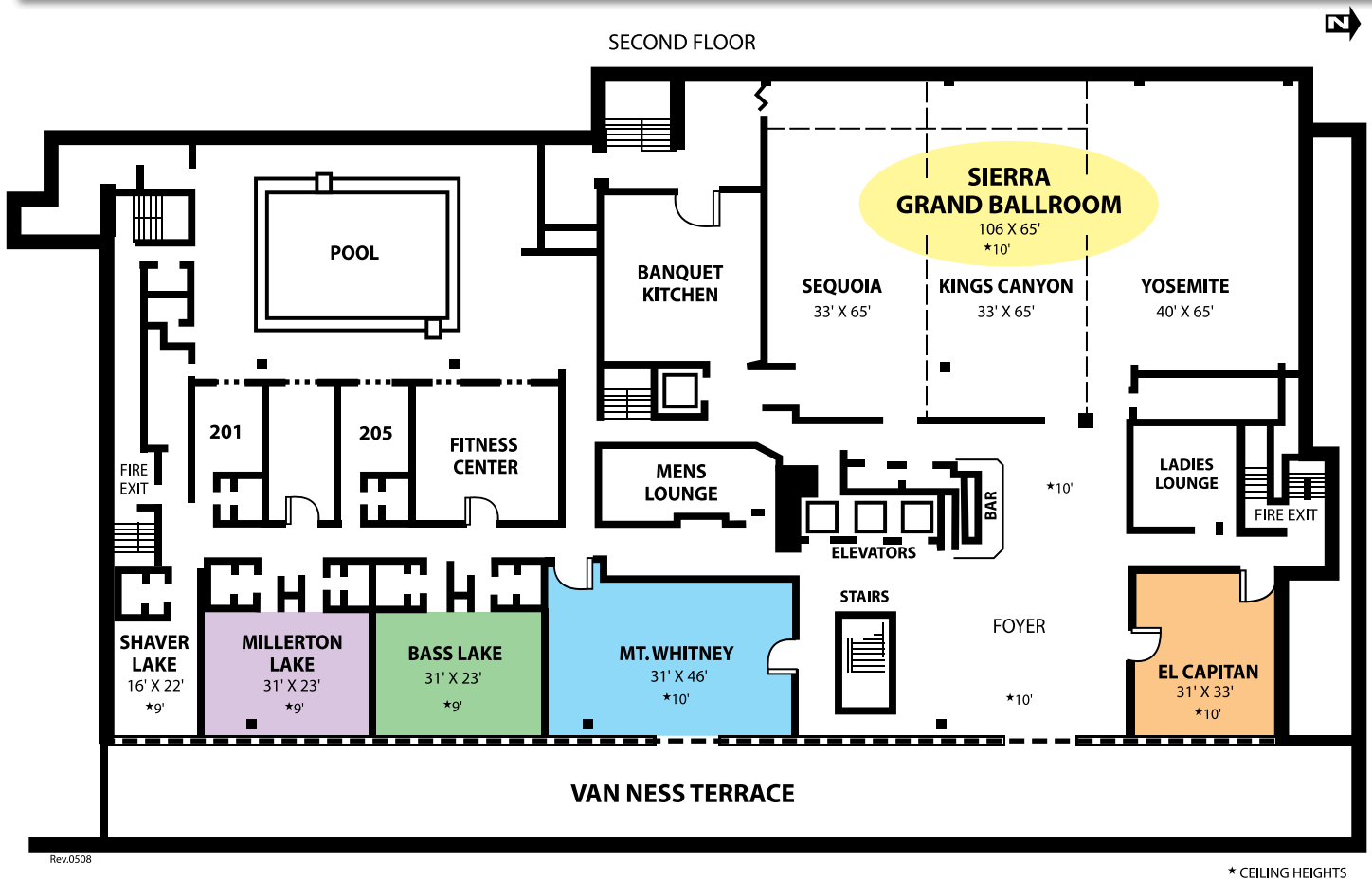

Concurrent Sessions 1		
10:30 – 11:45	QRIS 101: Understanding the Matrix, Assessment and California State Block Grant	Mt. Whitney
	QRIS & County Offices of Education: Leveraging Partnerships to Succeed	El Capitan
	Cross-Agency Collaboration: County Office of Education, First 5 Commissions, Child Care Resource Referral Agencies and Community Care Licensing	Bass Lake
	Preparing Your Team for a Quality Rating	Millerton Lake
Concurrent Sessions 2		
12:45 – 2:00	Using Data to Inform Quality Improvement Activities	Mt. Whitney
	Communicating Strategically About QRIS	El Capitan
	Building a Great Early Childhood Workforce	Bass Lake
	Coaching and Assessment	Millerton Lake

SCHEDULE AT A GLANCE

8:30 am – 9:00 am **Registration and Breakfast**

9:00 am – 9:15 am **Welcoming Remarks**

Jim Yovino, Superintendent
Fresno County Office of Education

9:15 am – 10:15 am **Keynote Conversation**

Camille Maben, Executive Director
First 5 California

10:15 am – 10:30 am **Break**

10:30 am – 11:45 am **Concurrent Sessions 1**

11:45 am – 12:45 pm **Networking Lunch**

12:45 pm – 2:00 pm **Concurrent Sessions 2**

2:00 pm – 2:15 pm **Break**

2:15 pm – 2:50 pm **Voices from the Field:
Sustainable Changes through QRIS**

Moderator:

Lupe Jaime, Director, Early Care and Education
Fresno County Office of Education

Panelists:

Liz Andrade-Stiffler, Central Unified School District
April Barajas, Children's Services Network
Cora Ramos, Central Unified School District
Megan Tupper, Kings Canyon Unified School District
Isela Turner, Fresno County Office of Education

2:50 pm – 3:00 pm **Closing Remarks**

Lupe Jaime, Director, Early Care and Education
Fresno County Office of Education

3:00 pm **Adjourn**

SESSIONS 1 10:30 AM - 11:45 AM

QRIS 101: Understanding the Matrix, Assessment and California State Block Grant Funding

Mt. Whitney

If you are new to QRIS, don't miss this session! Discuss QRIS and the early learning landscape in California, including a thorough review of the rating matrix and its tiers. Additionally, gain an overview of the CLASS and ERS tools, and hear about funding opportunities provided by the California State Block Grant.

Presenters: Serene Yee and Cecilia Fisher-Dahms, California Department of Education; Lupe Jaime, Fresno County Office of Education

Facilitator: Patricia Angel, Fresno County Office of Education

QRIS and County Offices of Education: Leveraging Partnerships to Succeed

El Capitan

What strategic quality initiatives exist in your county and how do you use them to leverage partnerships, align goals and use resources effectively? This session is designed for county office of education administration and staff who are implementing or interested in a QRIS. The session will highlight innovative partnerships between county offices of education and First 5 Commissions, housing agencies, school districts, resource and referral agencies, institutions of higher education, professional development providers and others to promote the sustainability and impact of QRIS. Session participants will have an opportunity to brainstorm how the California State Preschool Programs (CSPP) Block Grant can support and maintain quality and ideas to support non-CSPP sites. This interactive session will include time for discussion regarding challenges and potential solutions.

Presenters: Dr. Michele Cantwell-Copher, Fresno County Office of Education; Dr. Natalie Woods Andrews, Sacramento County Office of Education; Carrie Murphy, Ventura County Office of Education

Facilitator: Christina Bath Collosi, VIVA Strategy + Communications

Cross-Agency Collaboration: County Office of Education, First 5 Commissions, Child Care Resource Referral Agencies and Community Care Licensing

Bass Lake

In many counties, collaboration among local agencies has been critical to the success of QRIS. In Fresno County, a strong relationship among the Fresno County Office of Education, Children's Services Network, First 5 Fresno County, and Community Care Licensing has allowed for the sharing of resources and information about best practices. These partnerships have also led to a searchable database, where parents can search for quality early care and education sites. These partners will share lessons learned about collaboration along the way.

Presenters: Hannah Norman, First 5 Fresno County; Gayle Duffy, Children's Services Network; Valerie Reed and Rebecca Varela, Community Care Licensing; Isela Turner, Fresno County Office of Education

Facilitator: Isela Turner, Fresno County Office of Education

Preparing Your Team for a Quality Rating

Millerton Lake

Providers and site administrators, learn how to prepare for a quality improvement rating, including what sites can expect the day of the rating and what additional resources are available to sites after the rating is complete.

Presenters: Kayla Wilson, Fresno County Office of Education; Susan McGraw, Progressive Early Assessments

Facilitator: Isidro Bruno, Fresno County Office of Education

SESSIONS 2

12:45 PM - 2:00 PM

Using Data to Inform Quality Improvement Activities

Mt. Whitney

The primary goal of QRIS is to improve outcomes for our youngest learners. This interactive session will provide information to participants on how data systems can be utilized to inform improvement activities. Time will be allocated for participants to share data challenges, solutions and ask questions of the presenters.

Presenters: Claire Crandall and Laura McLean, San Diego Office of Education

Facilitator: Amber Jacobo, Fresno County Office of Education

Communicating Strategically About QRIS

El Capitan

Communicating strategically about QRIS with parents, providers, policymakers and educational leaders is essential to the success of your initiative. Learn about the importance of brand identity and targeted communications materials and see how some QRIS's have communicated with their key stakeholders. Walk away with "lessons learned" and strategies to adopt in your community.

Presenters: Lupe Jaime, Fresno County Office of Education; Diane Ehrle, Orange County Office of Education; Samantha Thompson, Merced County Office of Education

Facilitator: Christina Bath Collosi, VIVA Strategy + Communications

Building a Great Early Childhood Workforce

Bass Lake

There is no 'one size fits all' method for supporting the early childhood workforce. Panelists will share their innovative strategies and supports for meeting the needs of the workforce and how collaborating with community based agencies and institutions of higher education made it happen! You'll also hear about the California Early Care and Education Workforce Registry and how it is positioned to support the entirety of the workforce.

Presenters: Rosa Barragan, Merced County Office of Education; Mary Beth Miller, Fresno City College; Kimmy Nguyen, WestEd E3 Institute; Elise Crane, Office of Early Care of Education, City and County of San Francisco

Facilitator: Mary Ann Cusator, Fresno County Office of Education

Coaching and Assessment

Millerton Lake

Learn from counties who are successfully meeting the coaching and assessment requirement for QRIS. They will share their coaching models and key takeaways for coaching and assessment implementation. Discuss how to best deliver information to coaches and clients as well as models for sharing information on ERS, CLASS, DRDP, and ASQs with providers.

Presenters: Jocelyn Tucker, Los Angeles County Office of Child Care; Zenaida Meza, Child Care Alliance of Los Angeles; Fiona Stewart, Child Care Alliance of Los Angeles

Facilitator: Amy Carnahan, Fresno County Office of Education

THANK YOU

The success of the Summit is due in large part to the collaborative spirit of educational leaders dedicated to improving the lives of young children in Fresno County and throughout California.

Thank you to the Fresno County Office of Education Summit Planning Committee.

Patricia Angel

Mary Ann Cusator

Sylvia Torres

Isidro Bruno

MaryEllen Galvan

Isela Turner

Michele Cantwell-Copher, Ed.D.

Lupe Jaime

Christine Villegas

Amy Carnahan

Amber Jacobo, Ed.D.

Kayla Wilson

Edelmira "Memi" Chavez

Kristen Reitz

Jim Yovino

Thank you to the Early Stars Steering Committee for their support designing and implementing Fresno County's QRIS. Your expertise has been fundamental to the success of our program.

Tal Ben-Ami

Program for Infant/
Toddler Care

Charmaine Fitzgerald

Community Leader,
Child Advocate

Laura Mitchell

Fresno Unified School District

Elizabeth Andrade-Stiffler

Central Unified School District

Emma Gonzalez

Emma's Child Care

Hannah Norman

First 5 Fresno County

Christina Bath Collosi

VIVA Strategy +
Communications

Carol Gossett

Fresno Pacific University

Tamala Olsby

Fresno Economic Opportunities
Commission - Head Start

Mary Ann Cusator

Fresno County Office of
Education

Shirley Harris

Jack and Jill's
Educational Center

Isela Turner

Fresno County Office of
Education

Diana Decker

California Preschool
Instructional Network

Lupe Jaime

Fresno County Office of
Education

Marialusia Villasana

Aly's Angels Family Child Care

Gayle Duffy

Central Valley Children's
Services Network

Mary Beth Miller

Fresno City College

Cathy K Yun, Ph.D.

California State University,
Fresno